

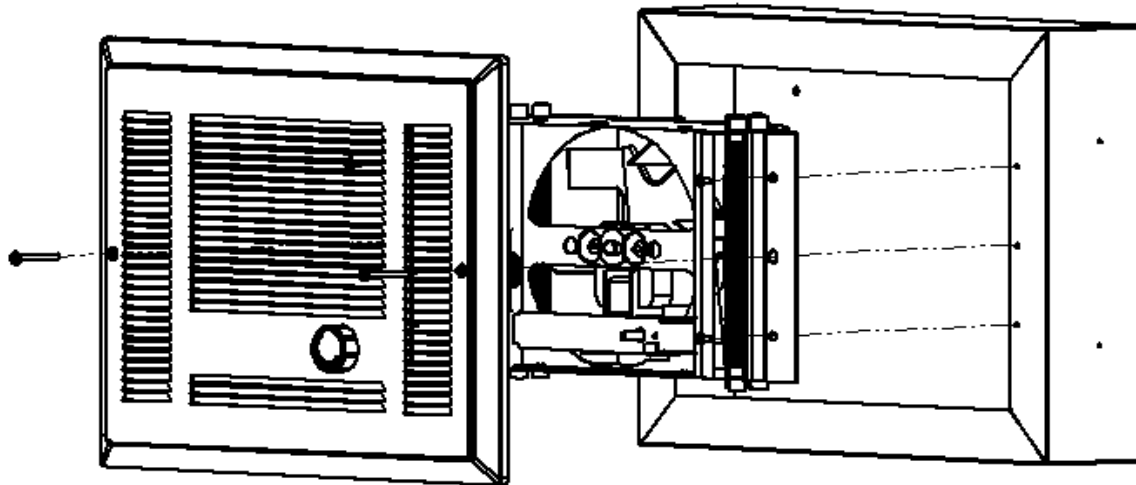

The SL Surface Mount Adapter

Surface Mount Metal Adapter Installation Guide for Model SLC-5



SL Grill

SL Heater Assembly

SL Wall Can Surface Mount

Tools Required:

• Phillips Screwdriver • Appropriate Wire Nuts • Appropriate Fasteners • Strain Relief Connector

Important Information

If you are uncomfortable working with electrical appliances, unable to follow these guidelines, or do not have the necessary equipment; consult a licensed electrician.

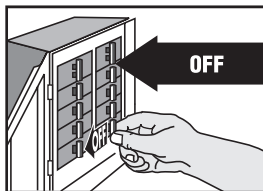

⚠ WARNING

Turn the electrical power off at the electrical panel board (circuit breaker or fuse box) and lock or tag the panel board door to prevent someone from turning on power while you are working on the heater. Failure to do so could result in serious electrical shock, burns, or possible death.

Installation Instructions

INSTALLATION:

1. Read and understand heater instructions found in the model SL Owner's Guide.
2. Remove wall can knockout closest to the supply wires. Right side only.
3. Mount the wall can securely to the wall, paying attention to minimum heater clearances.
4. Feed the supply wires through the knockout using an appropriate strain relief connector (not provided).
5. Feed the supply wires into the heater wall can clamps located at back of wall can.
6. Wire the heater according to the installation instructions included with the heater and connect ground to grounding lug.
7. Screw the heater to the wall can using the four screws provided with heater.

Save These Instructions

TEL: 360-693-2505 Fax: 360-694-8668 P.O. Box 1675 Vancouver, WA 98668-1675